

Aquatec® Pure Bidet

en Shower toilet
User Manual



This manual **MUST** be given to the user of the product.
BEFORE using this product, read this manual and save for future reference.

AQUATEC®



Yes, you can.®

©2017 Invacare Corporation

All rights reserved. Republication, duplication or modification in whole or in part is prohibited without prior written permission from Invacare. Trademarks are identified by ™ and ®. All trademarks are owned by or licensed to Invacare Corporation or its subsidiaries unless otherwise noted.

Contents

1 General	4
1.1 General information	4
1.2 Symbols in this user manual	4
1.3 Warranty	4
1.4 Compliance	4
1.5 Intended use	5
1.6 Service life	5
2 Safety	6
2.1 Safety information	6
2.2 Safety information on electromagnetic compatibility	7
2.3 Labels and symbols on the product	8
3 Components	9
3.1 Components	9
3.2 Functional description of the self-cleaning mechanism	10
4 Setup	11
4.1 Installation / Assembly	11
4.2 Assembling concealed cistern	14
4.3 Trial operation	15
4.4 Disassembly	16
5 Usage	18
5.1 Safety information	18
5.2 Using the unit control panel and remote control	18
5.3 Using the shower toilet	19
6 Transport	24
6.1 Safety information	24
7 Maintenance	25
7.1 Maintenance and servicing	25
7.2 Cleaning and care	25
7.3 Freeze prevention during winter	26

7.4 Changing batteries of remote control	26
8 After Use	28
8.1 Storage	28
8.2 Re-use	28
8.3 Disposal	28
9 Troubleshooting	29
9.1 Identifying and repairing faults	29
10 Technical data	31
10.1 General data	31
10.2 Materials	32
10.3 Environmental Parameters	32

1 General

1.1 General information

This user manual contains information and notes on the proper and safe use of the bidet.

Please read this user manual carefully before using the product. Please heed all the notes, particularly the safety information, and act accordingly.

The position specifications (A, B, C, ...) in the handling instructions always refer to the preceding figure.

1.2 Symbols in this user manual

In this user manual, warnings are marked with symbols. The title next to the warning symbol indicates the level of danger.



DANGER

Indicates an immediate danger that will result in serious injury or death if not avoided.



WARNING

Indicates a dangerous situation which could lead to death or serious injury if not avoided.



CAUTION

Indicates a dangerous situation which could lead to minor injuries if not avoided.



IMPORTANT

Indicates a dangerous situation which could lead to damage if not avoided.



Useful tips, recommendations and information to ensure efficient and smooth operation.



This product complies with the directive 93/42/EEC for medical products. The launch date for this product is specified in the CE declaration of conformity.



Manufacturer

1.3 Warranty

We provide a manufacturer's warranty for the product in accordance with our General Terms and Conditions of Business in the respective countries. Warranty claims can only be made through the provider from whom the appliance was obtained.

1.4 Compliance

Quality is fundamental to the company's operation, working within the discipline of ISO 13485.

The product meets the requirements of EN 1717 (Protection against pollution of potable water installations and general requirements of devices to prevent pollution by backflow).

Invacare is continuously working towards ensuring that the company's impact on the environment, locally and globally, is reduced to a minimum.

- We comply with the current environmental legislation (e.g. WEEE and RoHS directives).
- We only use REACH compliant materials and components.

- We are compliant with the Water Regulations Advisory Scheme (WRAS).

For further information please contact Invacare in your country (for addresses, see back page of this manual).

1.5 Intended use

This product is intended exclusively as an aid for going to the toilet in domestic settings. Any other use is prohibited. The product may be used without an assistant only by persons who are physically and mentally able to safely deal with it.



WARNING!

Risk of injury

Any other or incorrect use could lead to hazardous situations.

- Do not use the product as a transfer aid.
- Never stand on the product.

Indications

Toilet attachments with cleansing function are necessary with illnesses or disabilities that due to considerable functional deficits of the upper extremities, comparable to being without hands or arms, make it impossible for the patient to clean the genital area the usual way on his or her own after use of the toilet.

1.6 Service life

If the product is used as intended and in accordance with the safety regulations, the expected product life is 5 years. The effective service life can vary, however, depending on the frequency and intensity of use.

2 Safety

2.1 Safety information

**DANGER!****Electric shock hazard**

- Do not open or repair the product. In case of damages, consult your authorized dealer.
- Do not use the product while bathing and do not pour or spray water on the unit.
- Always unplug the appliance during cleaning.
- Do not place or store product where it can fall or be pulled into a tub or sink and do not place or drop product into water or other liquid.
- Do not reach for a product that has fallen into water. Unplug immediately.
- Do not use damaged or loose power cord.
- Damaged power cords must be replaced by the manufacturer or an authorized dealer.
- Do not touch the power plug with wet hands.
- Never operate this product if it has a damaged cord or plug, if it is not working properly, if it has been dropped or damaged, or dropped into water
- Never drop or insert any object into any opening or hose.
- Do not cover up the warm air outlet or insert hands or other objects.
- Keep the power cord away from heated surfaces.
- Only connect the product to an outlet corresponding to the rated voltage of the unit.
- Before removing the unit from the toilet bowl, disconnect the power plug first.

**WARNING!****Risk of injury**

- For assembly only use the fastening materials included within the scope of delivery.
- Do not make any unauthorized changes or alterations to the product.
- Never block the air openings of the product and keep the air openings free of lint, hair, and the like.
- Never use while sleeping or drowsy.
- Do not operate where aerosol(spray) products are being used or where oxygen is being administered.
- Make sure that children do not play with the product.
- Make sure that persons (including children) with reduced physical, sensory or mental capabilities use the product without close supervision only if they are able to safely deal with the product.
- Do not use high pressure or steam cleaners.
- Keep the unit away from fires or inflammable substances.
- Do not connect product to industrial water supplies.
- Do not put any lighted cigarette or burning material in the toilet.
- Never stand on or place objects on the product.

**IMPORTANT!****Risk of damage to the product**

- Do not slam down the lid.
- Do not lean on the lid.
- Do not sit on the lid.
- When not in use for a long period of time, disconnect the power plug and drain the water tank.
- Do not twist or pull the connection hoses.

2.2 Safety information on electromagnetic compatibility

This product was successfully tested to international standards for its electromagnetic compatibility. However, electromagnetic fields such as those generated by radio and television transmitters, radio equipment and mobile telephones, can influence the operation of products with electrical drives. The electronic used in this product can also cause weak electromagnetic interference but this lies below the statutory limits. You should therefore observe the following warnings:

**CAUTION!****Electromagnetic interference**

- Wireless communications equipment such as WLAN routers, mobile phones, cordless telephones and their base stations or walkie-talkies can affect this equipment.
- Make sure that such devices are kept in a distance of at least 2 m away from the product.
 - If other electrically operated medical products cause a interference or are themselves disrupted, switch off your Invacare® product and contact your dealer.



Guidance and manufacturer's declaration relating to electromagnetic emission and immunity are available on request from Invacare® in your country.

2.3 Labels and symbols on the product

The identification label is applied to the rear side of the product and contains following information:

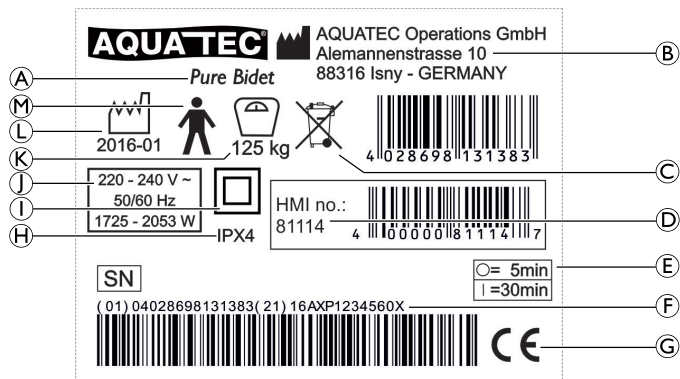

	Read user manual
	WRAS approved product

Ⓐ	Device designation	⒣	Type of protection
Ⓑ	Manufacturer	Ⓓ	Class II equipment
Ⓒ	Note (disposal)	Ⓙ	Nominal voltage / rated power
Ⓓ	HMI number	Ⓚ	Maximum user weight
Ⓔ	Interval of use: Max. 30 minutes continuous use followed by a 5 minutes break.	Ⓛ	Production date
Ⓕ	Serial number	Ⓜ	Type B applied part
Ⓖ	Conformity mark		

3 Components

3.1 Components

The following components are included within the scope of delivery:

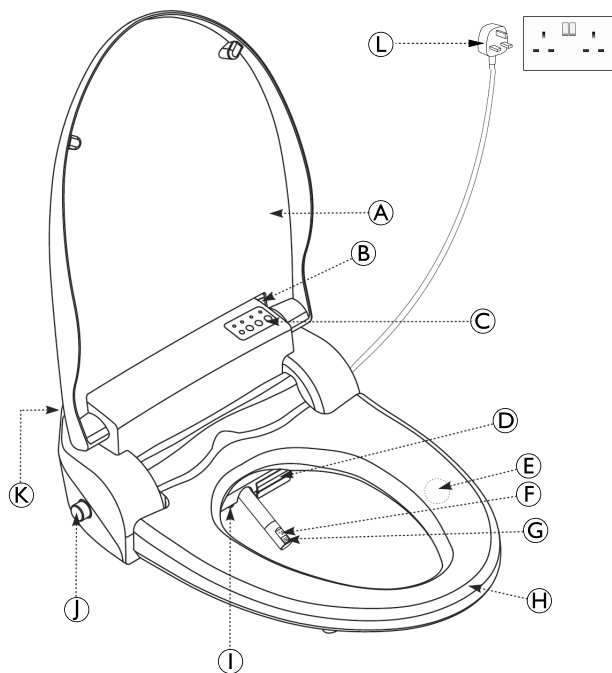

(A)	Lid
(B)	Remote control receiver
(C)	Control panel
(D)	Outlet of warm air dryer
(E)	Seat sensor
(F)	Cleansing nozzle
(G)	Bidet nozzle
(H)	Heated seat
(I)	LED Night-light
(J)	Inlet adapter
(K)	Remote control receiver
(L)	Power plug

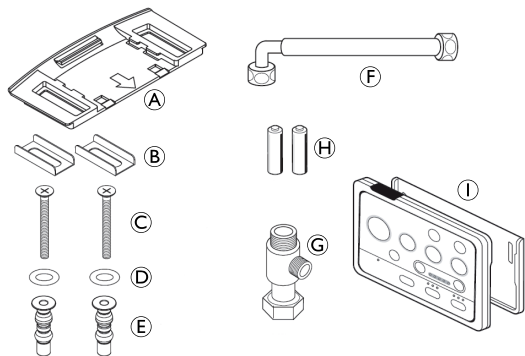

Ⓐ	Catch plate
Ⓑ	Brackets (2x)
Ⓒ	Fixation bolts (2x)
Ⓓ	Washers (2x)
Ⓔ	Packing nuts (2x)
Ⓕ	PVC Flexible hose (for main unit)
Ⓖ	T-valve
Ⓗ	Batteries for remote control
Ⓘ	Remote control and holder

3.2 Functional description of the self-cleaning mechanism

The self-cleaning mechanism of the showering and cleansing nozzle is automatically activated before and after each function / use.

The showering and cleansing nozzle is automatically retracted and rinsed with fresh water for approx. 5 seconds. Since the shower and cleansing nozzle is at this time within the device, water cannot be splashed when the lid is open. When pressing a function key, the nozzle moves out again and is ready for use.

When the device had been in standby-mode or had been re-connected to the power supply, the self-cleaning mechanism is activated once.

4 Setup

4.1 Installation / Assembly

Assembling the shower toilet

 The Aquatec® Pure Bidet fits standard and norm-WC's.



WARNING!

Risk of being scalded by hot water

– Only connect the shower toilet to a cold water supply.



WARNING!

– Check all the accessory parts are in place.
– Do not connect the power until installation is finalized.



The shower toilet is suitable for all types of water supply connection with a flushing cistern (top, bottom, sideways).



If the T-valve does not fit onto the water supply, adapter pieces are necessary.

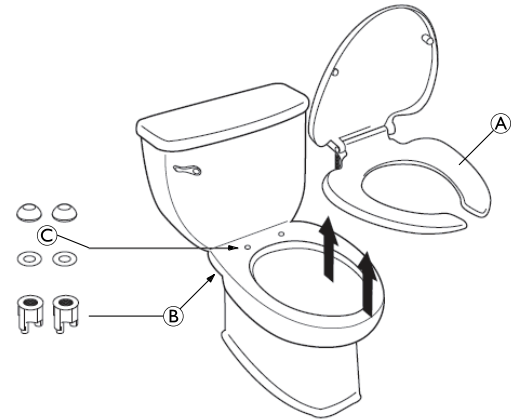

1. Unfasten the fixation nuts **B** of the existing toilet seat **A** underneath the toilet bowl.
2. Remove the toilet seat and keep it with the fixation parts **B** and **C** for later use.

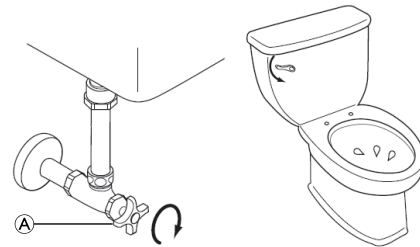

1. Close the shut off valve **A** clockwise.
2. Drain toilet water tank completely by flushing.

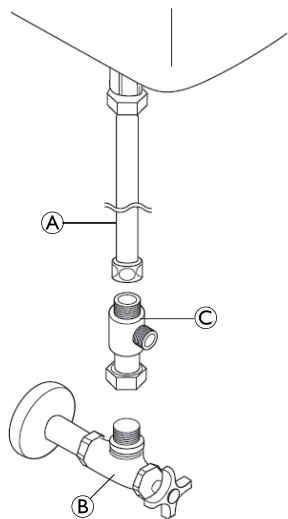

1. Detach the water supply hose **A** on the part of the shut off valve **B**.
2. Mount the T-valve **C** between shut off valve and water supply hose.

 If part **A** is a rigid pipe, it must be replaced by a flexible hose.

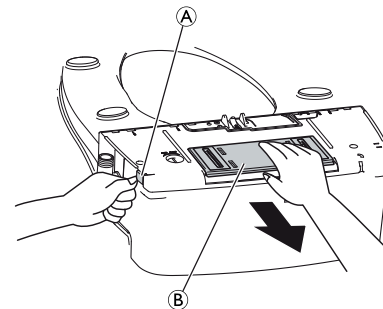

1. Press lever **A** to detach the holder plate **B** from the bidet.

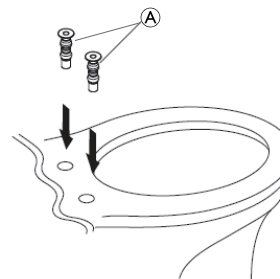

1. Insert the supplied packing nuts **A** into the fixing holes on the toilet bowl.

 One pair of standard packing nuts with a diameter of 14 mm are included in the package as an accessory part. If the fixing hole diameter on the toilet bowl is less than 14 mm other suitable packing nuts and washers need to be used.

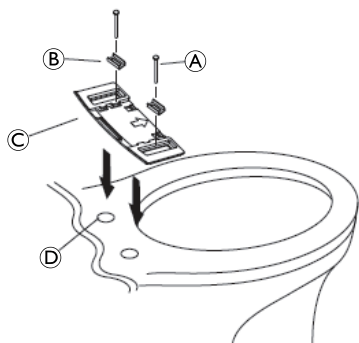

1. Put the washers ④ on both packing nuts.
2. Set in place the brackets ② on the catch plate ③.
3. Fasten the catch plate with the fixation bolts ① through the brackets in both packing nuts.

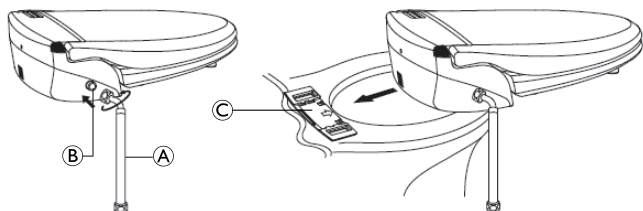

1. Screw the PVC flexible hose ① clockwise on the inlet adapter ② of the shower toilet.
2. Slide the shower toilet to the catch plate ③ installed.

**CAUTION!**

– Make sure that the grooves underneath the shower toilet are precisely guided in the recesses of the mounting plate.

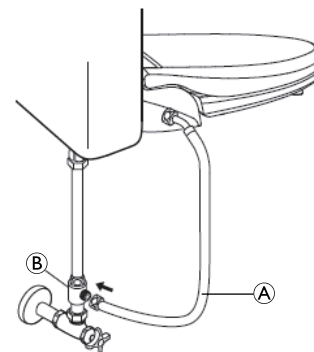

1. Screw the PVC flexible hose ① clockwise on the T-valve ②.

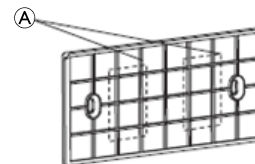
Attaching remote control holder

1. Attach the remote control holder with double stick tape ① on the wall in a suitable location.

Preparing the remote control

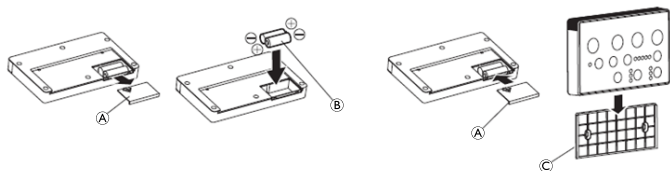

1. Remove battery cover (A) from remote control.
2. Insert batteries (B). Ensure correct polarity.
3. Close battery cover of remote control.
4. Place remote control (D) into its holder (C).

4.2 Assembling concealed cistern

Installing water flow over angle valve

1. Connect angle valve and bidet with the PVC Flexible hose (accessory).
2. Turn the water tap on.

! IMPORTANT!

– Check the connection for leaks and re-fit if necessary.

Installing water flow over flush-mounted housing

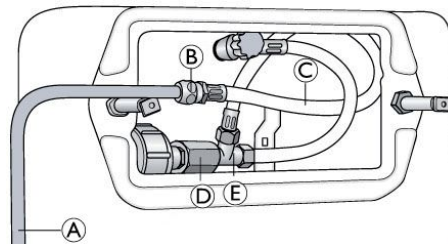

1. Remove the push plate from the flush-mounted housing.
2. Remove the rear cover plate to obtain a direct perspective on the connection.
3. Turn the water tap off.
4. Remove connecting sleeve (D) and replace by T-piece (E).
5. Connect T-piece with PVC Flexible hose (C).
6. Connect PVC Flexible hose with tube (A) using nut (B).
7. Connect tube (A) with pure bidet.
8. Turn the water tap on.

! IMPORTANT!

– Check the connection for leaks and re-fit if necessary.

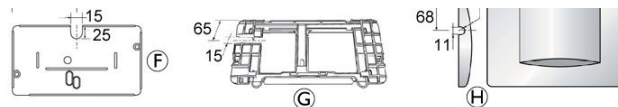

9. Cut-out inner cover plate (F), mounting plate (G) and push plate (H) according to the figure above taking into account the indicated dimensions [mm].

10. Re-attach the inner cover plate and the mounting plate inside the flush-mounted housing.
11. Close flush-mounted housing with the push plate.



Following parts are needed for the assembly of the flush-mounted water flow but are not included in the scope of delivery:

- Tube **A**
- Nut **B**

Available at your specialised dealer.

4.3 Trial operation

Leakage test

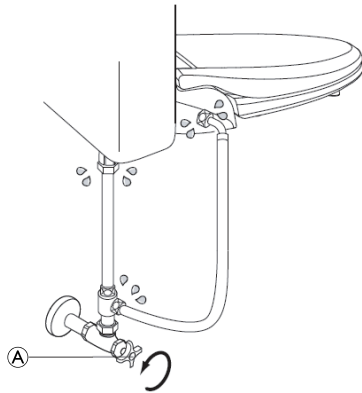

1. Open the shut off valve **A** completely by turning counterclockwise.
2. Check for any water leakage on the connection hoses, tighten if necessary.

Connecting the power plug



WARNING!

– This product must be wired in accordance with the latest edition of BS 7671 requirement for electrical installations (UK) or relevant equivalent wiring standards for your location/country.



IMPORTANT!

If this product is used in a bathroom or shower room, the supplied plug must be cut off and the connection to the power supply must be made via switched fused spur and RCD. No other appliance should share the spur with this product. The work must be carried out by a qualified electrician.

1. Read and follow the safety information regarding electrical safety, → *2.1 Safety information, page 6*.
2. Connect power plug to a suitable power source.



WARNING!

Electric shock hazard

– Do not turn over or move the unit after power connection.

3. If the power indication light is not turned on after the power plug connection, press any button except HI/LO, FR/BK buttons of the remote control, then power goes on.

Checking the key functions

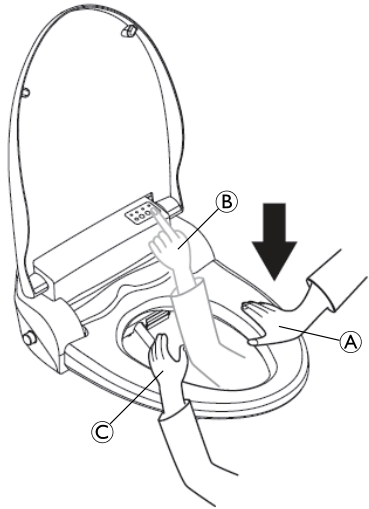

1. Place one hand on the seat sensor (A).
2. With the other hand press “CLEANSING / STOP” on the unit control panel (B) or “CLEANSING” or “BIDET” on the remote control.
 - Water sprays out of the nozzle. Cover the nozzle with your free hand (C) to prevent water spattering out.

4.4 Disassembly

Follow the below instructions if in need of detaching the unit for removal.

1. Disconnect the power plug.
2. Close the water supply by turning the shut off valve clockwise.
3. Drain the toilet water tank completely by flushing.
4. Disconnect the PVC flexible hose from the T-valve.

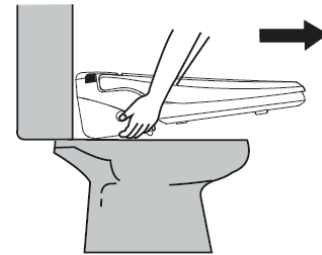

- Lift the device slightly and pull it forwards out of the holder.

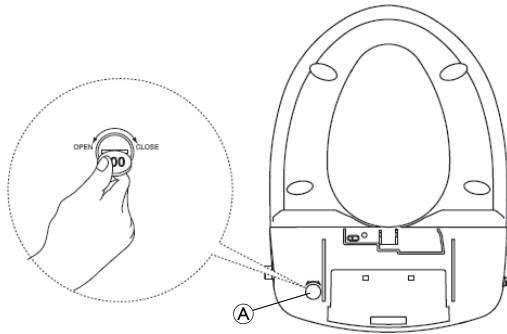

- Unfasten the drain plug **A** underneath the unit and drain the water completely out of the water tank.
- Disconnect the PVC flexible hose and T-valve.
- Connect the water-supply hose from the water tank to the shut off valve.
- Open the shut off valve by turning counterclockwise.
- Check the connections for any leakages, tighten if necessary.
- Reinstall the original seat and lid to the toilet.

5 Usage

5.1 Safety information



WARNING!

– Before usage read and follow the safety information, → 2.1 Safety information, page 6 .

5.2 Using the unit control panel and remote control

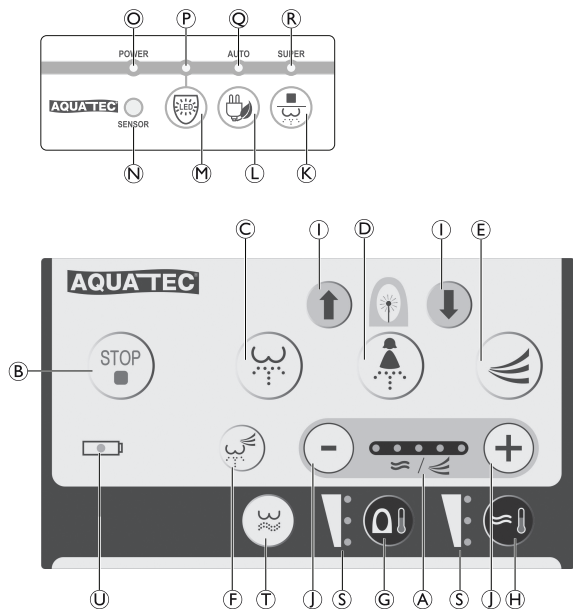

Overview of key functions on remote control		
Pos.	Key name	Function
Ⓐ	WATER / DRY	Display of the current water pressure or the temperature of the warm air dryer
Ⓑ	STOP	Stops all active functions
Ⓒ	CLEANSING/MOVE	Cleansing function is performed
Ⓓ	BIDET/MOVE	Bidet function is performed
Ⓔ	DRY	Warm air dryer function begins to operate
Ⓕ	AUTO	Automatic cleaning function starts
Ⓖ	SEAT	Adjusting seat temperature
Ⓗ	WATER	Adjusting water temperature
Ⓘ	FRONT / BACK	Change nozzle position
Ⓙ	HIGH / LOW	Adjusting warm air dryer temperature Adjusting water pressure
Ⓣ	HIP BATH	Hip bath cleansing is performed

Overview of key functions on remote control		
Pos.	Key name	Function
Ⓢ	HIGH / LOW	Display of current water temperature or seat temperature
Ⓤ	BATTERY SIGN	Illuminates when batteries need to be replaced



Overview of key functions on control panel		
Pos.	Key name	Function
Ⓚ	CLEANSING/STOP	Device turns off
Ⓛ	POWER SAVING	Power-saving mode activates
Ⓜ	LIGHT	Night-light activates
Ⓝ	LIGHT SENSOR	When night-light function is activated, bidet automatically senses toilet light and night-light LED switches on
Ⓞ	POWER	Illuminates when unit is switched on
Ⓟ	LIGHT	Illuminates when night-light is activated

Overview of key functions on control panel		
Pos.	Key name	Function
Ⓞ	AUTO	Illuminates when automatic power-saving mode is activated
Ⓡ	SUPER	Illuminates when super power-saving mode is activated

5.3 Using the shower toilet

Perform manual cleansing

 A sensor is located inside the toilet seat, that is only activated by skin contact.

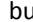
- If plugged-in, the device is turned on and the "POWER" LED  illuminates on the control panel.
 - If the "POWER" LED does not illuminate, press any button on the remote control (except HIGH/LOW or FRONT/BACK buttons).
- Set yourself centered on the toilet seat.
- Press the CLEANSING/MOVE button  or BIDET/MOVE button .
 - CLEANSING respectively BIDET-function is performed.
- Press again CLEANSING/MOVE button or BIDET/MOVE button during the cleansing process.
 - The cleansing nozzle moves back and forth. Nozzle stops by pressing the button again.

5. Press STOP button **(B)** on the remote control.
 - Shower procedure stops.
6. Press DRY button **(E)** on the remote control.
 - Warm air dryer is activated. Dryer function stops by pressing the “STOP” button.
7. Press CLEANSING/STOP button **(K)** and hold for more than 4 seconds.
 - The device is turned off — All displays switch off on the control panel.

i CLEANSING/MOVE and BIDET/MOVE function operates for 90 seconds. Hip bath function operates for 3 minutes. DRY function operates for 3 minutes. The functions are ending with an audible beep. Before and after each operation, the self nozzle cleaning function runs and sanitizes the nozzle head.

Perform automatic cleansing

The automatic cleansing function is a default function for people with disabilities, children or the elderly, in which a complete cleansing cycle is automatically executed.

1. Press AUTO button **(F)** on the remote control.
 - The 3rd level for water pressure, the 2nd level for warm air dryer temperature and the last setting of nozzle position are automatically set-up.
 - The Sensor forces to set the water- and seat temperature to “Medium”, in case the temperature were set up on the “High” position.
 - A buzzer sounds when the auto cleansing function finishes.
2. Press STOP button **(B)** on the remote control.
 - The automatic cleansing process is interrupted.
3. Press AUTO button **(F)** again.
 - The previous automatic cleansing process is resumed.

i Automatic cleansing function: Move cleansing and warm air dryer run for 1 minute each.

Setting water pressure

The water pressure can be set in three steps (indicated by first, middle and last LED):

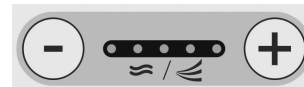

1. Press CLEANSING/MOVE button **Ⓢ** on the remote control.
2. Press HIGH respectively LOW button **Ⓛ** on the remote control.
 - The water pressure of the cleaning nozzle is raised or lowered by one step and displayed on the LED **Ⓐ**.

i The last set value of the water pressure is automatically saved by the device.

Setting nozzle position

1. Press FRONT respectively BACK button **Ⓛ** during cleansing function on the remote control.
 - The cleansing nozzles move forwards respectively backwards.

i When the cleansing process is complete and you move away from the seat, the nozzle moves back into the last setting of the nozzle position.

Setting water temperature

The water temperature can be set in four steps:



1. Press WATER button **Ⓜ** repeatedly on the remote control, until the desired temperature is reached.
 - The water temperature is displayed on the LED display above.

i If the cleaning functions are repeatedly started, the water temperature drops gradually. To regain the desired water temperature, suspend the cleaning function for three minutes. The last value of the water temperature is automatically saved by the device.

Setting seat temperature

The seat temperature can be set in four steps:



1. Press SEAT button **Ⓢ** repeatedly on the remote control, until the desired temperature is reached.
 - The seat temperature is displayed on the LED display above.

i The last value of the seat temperature is automatically saved by the device.

The seat is equipped with an internal combustion protection system. If the seat temperature is set to "High" and you remain longer than 30 minutes on the seat, the seat temperature drops automatically. As soon as you leave the seat, the temperature returns to the setpoint.

Setting warm air temperature

The warm air temperature can be set in five steps:



1. Press DRY button (E) on the remote control.
 2. Press HIGH respectively LOW button (I) on the remote control.
 - The temperature of the warm air dryer is raised or lowered by one step and displayed on the LED (A).
-  The last value of the warm air dryer temperature is automatically saved by the device.

Turning on/off night-light LED

1. Press LIGHT button (M) on the units control panel.
 - The night-light is activated when it gets dark in the room.
-  When the night light is activated, the device automatically recognizes the toilet light and the night light is turned off. The User can conveniently bidet without toilet light. The power consumption of the night-light is very low.
2. Press LIGHT button again to switch off the night-light.

Automatic power saving mode

1. Press POWER SAVING button (L) repeatedly, until “AUTO” LED (C) illuminates.
 - Seat temperature is automatically set at 30 °C
-  Auto power saving function is temporarily released, when sitting on the seat. Auto power saving function runs again, when moving away from the seat.
2. Press POWER SAVING button twice.
 - Power saving mode deactivates and “AUTO” LED turns off.

Super power saving mode

Bidet senses toilet luminosity for itself and shows excellent power saving function.

1. Press POWER SAVING button (L) repeatedly, until “SUPER” LED (R) illuminates.
 - Water and seat temperature maintain normal temperature.
-  Power saving mode is temporarily released when toilet light turns on. It returns to normal mode from power saving mode even if occupying the seat in dark condition.
2. Press POWER SAVING button once.
 - Power saving mode deactivates and “SUPER” LED turns off.

Perform hip bath function

1. Press HIP BATH button  on the remote control.

 The hip bath function operates for 3 minutes (The nozzle moves slightly forwards and backwards).The lowest level of water pressure and the highest level of water temperature is pre-set.

2. Press HIP BATH button again to stop the nozzle moving forwards and backwards.
3. Press STOP button to cancel the hip bath function.

6 Transport

6.1 Safety information



IMPORTANT!

Risk of damage to the product

- Only transport the product in dry areas at temperatures between 0 °C and 40 °C, air pressure of 795 hPa - 1060 hPa and humidity of 30% - 75%.
- Do not expose the product to direct sunlight.

7 Maintenance

7.1 Maintenance and servicing

If the cleaning and safety notices are observed, the product will be maintenance free.



WARNING!

- Check the product regularly for damage and to ensure that it is securely assembled.
- In the event of damage and/or necessary repairs, contact the dealer immediately.
- The product must be checked by an authorized dealer before every re-use or after 24 months at the latest (see Manufacturer's recommendation for rehab products of the SPECTARIS industrial association).

7.2 Cleaning and care



WARNING!

Electric shock hazard

- Do not touch the power socket with wet hands.
- Disconnect the power plug from the wall outlet before cleaning the unit.
- Make sure that no water splashes to the plug or the wall outlet.
- Observe the safety information for electrical safety, → *2.1 Safety information, page 6*.

! IMPORTANT!

- Hygiene is particularly important in a sensitive area like the toilet.
 - Keep the product clean and wash it regularly.

! IMPORTANT!

- All cleaning agents and disinfectants used must be effective, compatible with one another and must protect the materials they are used to clean.
 - For further information on decontamination in Healthcare Environments, please refer to 'The National Institute for Clinical Excellence' guidelines on Infection Control www.nice.org.uk/CG139 and your local infection control policy.
 - Do not dry-clean the device.
 - Clean the product by hand.
 - Do not use abrasive cleaning agents.

Cleaning the shower toilet

1. Clean the unit with moist, well-wrung soft cloth. For excessive stains, use soft cloth moistened with mild detergent solution
2. Wipe out the device with a dry cloth.

Cleaning the water strainer

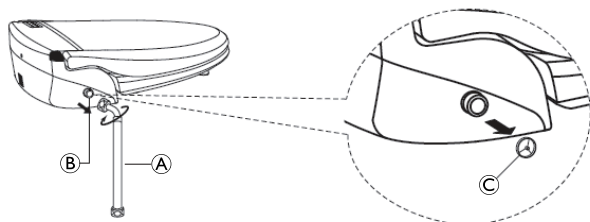

1. Close the water supply by turning the shut off valve clockwise.
2. Detach the PVC flexible hose (A) from the inlet adapter (B).
3. Detach the strainer (C) from the inlet adapter with a pointed object.
4. Thoroughly clean the strainer with a soft brush.
5. Reinsert the strainer on the inlet adapter.
6. Attach the PVC flexible hose to the inlet adapter.
7. Open shut off valve fully by turning counterclockwise.

Cleaning the nozzles

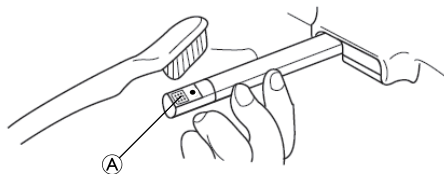

1. Press “CLEANSING / STOP” and “POWER SAVING” buttons simultaneously on the control panel.
 - The nozzle (A) comes out and stops.
2. Clean the nozzle manually with a soft brush.
3. Press “CLEANSING / STOP” button.
 - The nozzle returns to its storage position and the self cleaning function is automatically activated.

Disinfecting the shower toilet

1. Disinfect the product by wiping down all generally accessible surfaces with commercially available disinfectants.
2. Thoroughly wipe clean the treated surfaces with a damp cloth.
3. Thoroughly dry the surfaces with a clean, dry cloth.

7.3 Freeze prevention during winter

1. Connect the power plug and check if the power unit is on.
2. Press WATER on the remote control, until the water temperature is set to "Low" or higher, see 5.3 Using the shower toilet, page 19.

7.4 Changing batteries of remote control

The battery life cycle depends on the frequency of use.

**CAUTION!****Risk of remote control explosion**

- Only use batteries of type AA (LR6) 1.5 V.
- Insert batteries according to the +/- indicator in the remote control.
- Do not use old and new batteries together.

1. Change used batteries into new ones when “BATTERY SIGN” LED blinks on the remote control, see *Preparing the remote control, page 14*.

8 After Use

8.1 Storage



IMPORTANT!

Risk of damage to the product

- Store the product in a dry area at a temperature of between 0 °C and 40 °C, air pressure of 795 hPa - 1060 hPa and humidity of 30% - 75%.
- Do not store the product near heat sources.
- Keep the product out of direct sunlight.



IMPORTANT!

- If not in use for a long time, drain the water tank completely, → 4.4 *Disassembly, page 16*.

8.2 Re-use

The product is suitable for re-use. The number of re-uses depends on the frequency of use and the manner in which the product was used.

Before re-use, the product should undergo hygienic treatment and be checked to ensure it is in proper and safe working order. In need of repair contact authorized dealer.

8.3 Disposal

The disposal and recycling of used products and packaging must be conducted in accordance with the applicable legal regulations.

The manufacturer can handle the correct and complete disposal of the device.

This product contains batteries. Old batteries may contain hazardous substances which could be a danger to the environment and public health.

Dispose of batteries according to your local regulations.

9 Troubleshooting

9.1 Identifying and repairing faults

Fault	Possible cause(s)	Remedy
Unit does not operate at all	Power is off Power plug is not connected There is a power failure	Press any button to check except "HIGH", "LOW", "FRONT" or "BACK" buttons of the remote control.
CLEANSING, BIDET, DRY, AUTO do not operate	Seat is covered	Make sure that there is nothing on the seat surface. (The device is only activated when the user's skin touches the seat sensor.)
Remote control does not operate at all	Batteries in the remote control have been exhausted	Replace batteries with new ones, → 4.1 <i>Installation / Assembly</i> , page 11.
Malfunction of the remote control	Batteries are empty or too weak Remote control out of reach of the device	Replace batteries with new ones, → 4.1 <i>Installation / Assembly</i> , page 11.
No water spray	The shut off valve is closed	Open shut off valve.
	There is water supply outage	Restore water supply.
Low water pressure	The water pressure level is set to "LOW"	Increase water pressure level, → 5.3 <i>Using the shower toilet</i> , page 19.
	The water strainer is clogged	Clean water strainer, → 7.2 <i>Cleaning and care</i> , page 25.
	Nozzle head is dirty	Clean nozzle, → 7.2 <i>Cleaning and care</i> , page 25.

Fault	Possible cause(s)	Remedy
Low water temperature	The water temperature level is turned off or set to "LOW"	Turn on or increase water temperature level, → 5.3 <i>Using the shower toilet, page 19.</i>
Seat is not warm	The warm seat temperature level is turned off or set to "LOW"	Turn on or increase seat temperature level, → 5.3 <i>Using the shower toilet, page 19.</i>
Dryer air is not warm	The warm air dryer temperature level is turned off or set to "LOW"	Turn on or increase warm air dryer temperature level, → 5.3 <i>Using the shower toilet, page 19.</i>

10 Technical data

10.1 General data

Power supply	220 – 240 V AC, 50/60 Hz
Max. power consumption	1725 – 2053 W
Intermittent (periodic operation)	85%, 30 min. ON / 5 min. OFF
Type of protection, entire device	IP X4 ¹⁾
Length of power cord	1.4 m
Battery type remote control	2 x AA (LR6) / 1.5 V
Type water supply connection	Direct connection to the water supply
Ø Connection at shower toilet	1/2"
Ø T-piece	1/2" - 3/8" - 1/2"
Ø Connection hose	1/2" cranked to 3/8"
Length connection hose	500 mm
Water supply pressure	79 – 735 kPa
Water supply temperature	3 – 25 °C
Operating temperature	3 – 40 °C
Product width	389 mm
Product length	515 mm

Product depth	156 mm
Product weight	3.9 kg

Cleansing functions	
Water flow rate CLEANSING	0.7 l/min
Water flow rate BIDET	0.85 l/min
Water pressure adjustment	3 levels
Temperature adjustment	Normal water supply temperature, 34 °C, 37 °C, 40 °C
Heater capacity	1670 – 1987 W
Safety devices	Thermal fuse, Thermostat
Warm seat	
Temperature adjustment	Room temperature, 35 °C, 38 °C, 40 °C
Heater capacity	55 – 65 W
Safety devices	Thermal fuse
Drying functions	
Temperature adjustment	Room temperature – 50 °C (5 levels)
Heater capacity	195 – 232 W
Safety devices	Thermal fuse, Bi-metal

¹⁾ Protected against the penetration of water that is splashed against the housing from all directions (warm seat only).

10.2 Materials

Seat	PP
Lid	PP

All product components are corrosion resistant and Latex free.

10.3 Environmental Parameters

Operating conditions	
Ambient temperature	3 - 40 °C
Relative humidity	15 % - 93 %, non-condensing
Atmospheric pressure	795 - 1060 hPa
Storage and shipping conditions	
Ambient temperature	0 - 40 °C
Relative humidity	30 % - 75 %, non-condensing
Atmospheric pressure	795 - 1060 hPa

Invacare® distributors:

United Kingdom:

Invacare Limited
Pencoed Technology Park, Pencoed
Bridgend CF35 5AQ
Tel: (44) (0) 1656 776 222
Fax: (44) (0) 1656 776 220
uk@invacare.com
www.invacare.co.uk



Aquatec Operations GmbH
Alemannenstrasse 10
D-88316 Isny
Germany

1590852-C 2017-12-12



Making Life's Experiences Possible®

AQUATEC®



Yes, you can.®