

Robin[®] EVO

Supporting patients and carers



A new ceiling hoist with advanced technology

Focused on safe and dignified transfers



Feel safe and more connected with Robin® EVO

Based on our trusted Robin® design, the Robin® EVO is the next generation of ceiling hoist that includes advances in safe and effective transfers.

Its design maintains many of the Robin®'s popular features, but with a renewed focus on supporting

quality single handed care that offers reassurance for both the caregiver and patient.



1

Positive Patient Interaction

The 2-strap concept is designed to promote eye contact, effective communication and positive interactions between client and carer helping to reduce anxiety, increase trust and overall compliance.

2

Extra Safety Features

From the new LED display to the operating lights and emergency pull cord, the Robin® EVO design always considers safety first.

> **Extra reassurance thanks to a new LED display** that signals operation icons and error codes for troubleshooting.

> **Unprecedented stability** the 2-strap concept gives maximum stability and comfort during transfer. This helps the client feel safer and assured.

> **Transfer with dignity** With the absence of a spreader bar, patients feel less restricted and more connected during transfer. Greater patient engagement helps ensure a more dignified experience.

> **Eye contact with client** is maintained thanks to the 2-strap concept. Need for spreader bar is eliminated helping client/carers interactions.

> **Safety comes first** with emergency pull cord, electrical and mechanical lowering.

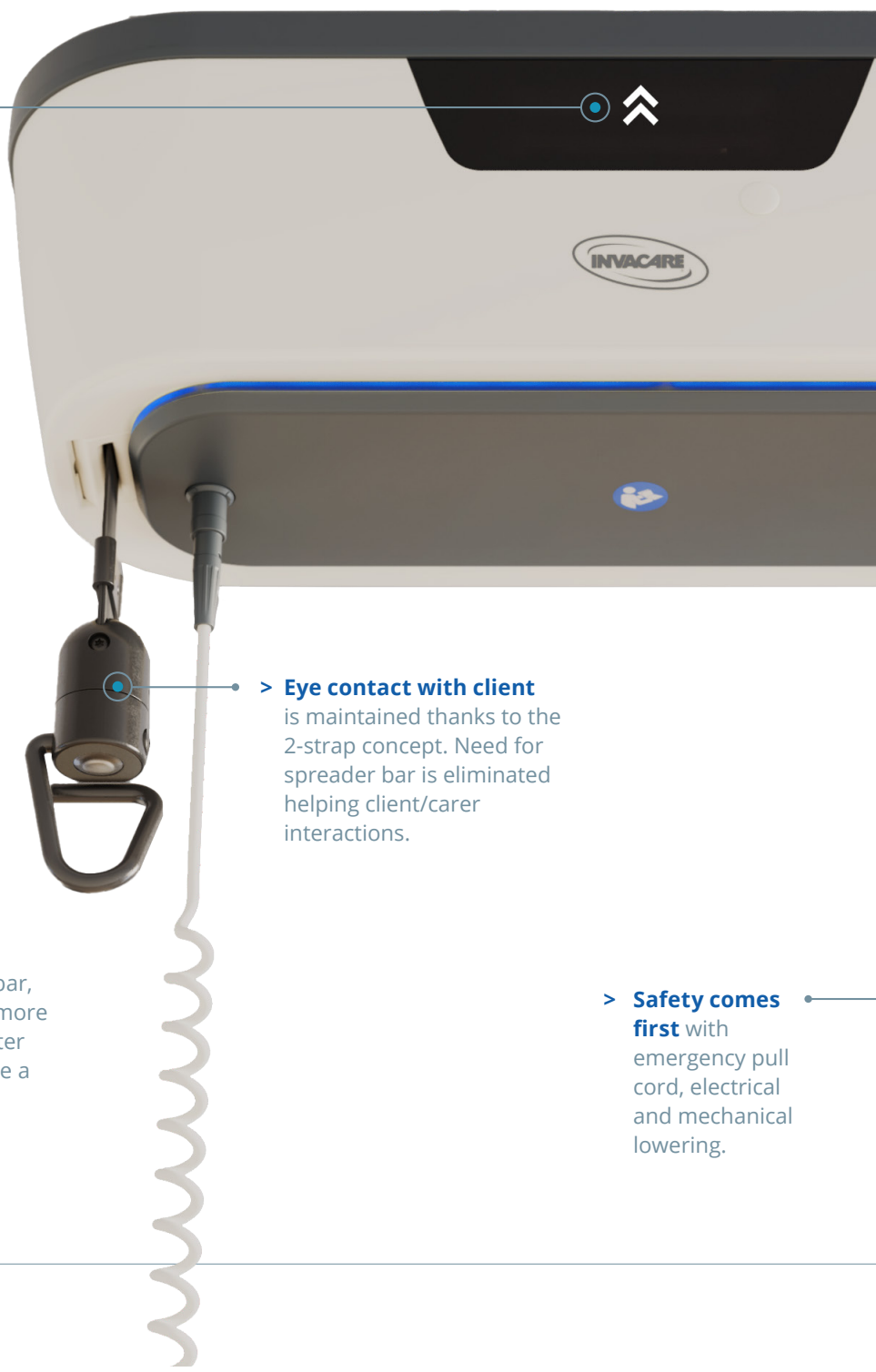

3

Even more efficiencies

The new design means more lifting cycles per charge, higher lifting speeds and an improved overall battery life.



> **Operation lights** glow blue when hoist is in use.

> **Easy to use hooks** securely holds the sling straps in place using weighted tension.



> **Battery power levels indicator** featuring 3 LED lights for added convenience. Magnetic hand control for easy fixation.



> **Greater efficiencies** achieved with Li-ion battery.



> **200 kg** safe working load.

An improved solution in supported transfers

The Invacare Robin® EVO is our new and improved ceiling hoist, designed to respond to today's challenges in residential and homecare settings.

Effective patient handling equipment helps prevent injuries and ensures a responsible and safe working environment for carers, family members as well as patients.



Supports Single handed care

Transfer procedures can be performed **by one carer**.



Effective for carers

Multiple studies have shown ceiling hoists do significantly **reduce the static load on carers**.



Dignity for patients

The Robin® EVO ceiling hoist is an efficient manual handling solution that focuses on the **dignity and safety of the client**.

Robin® EVO ceiling hoist is suitable for various home and residential care environments.





Sling Selection

Invacare slings are an essential addition to the Robin® EVO ceiling hoist. Each provides safe, supportive, and comfortable client transfers. All are carefully designed to work with the person's body shape, ensuring a perfect fit and offering the right support where required.

They come in thirteen models, each in up to six sizes and with three fabric options to choose from. There is an Invacare Sling suitable for everyone.



Technical data ▼

More information about this product, including the user manual, please visit our website: www.invacare.co.uk



Length of motor ▼

505 mm



Width of motor ▼

190 mm



Height of motor ▼

211 mm

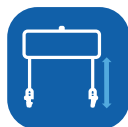

Strap length ▼

2,5 meter



Strap length increments ▼

4.2 cm/s Lifting speed without load
3.7 cm/s Lifting speed with 200 kg load



Total product weight ▼

9,5 kg



Max. user weight ▼

200 kg

Lifts per charge; Approx 90. (user weight 80 kg, 0.5 m up/down)

Voltage between battery/hoist; 24V DC

Voltage supply 100 – 240 V AC, 50 /60 Hz, 1A

ISO 10535:2021 compliant



Robin EVO is designed specifically for patients who are unable to independently mobilize and need support from caregivers. This level of mobility has been identified as level D and E, according to MK5's mobility classification.

In MK5 the functional mobility is classified into five levels (A, B, C, D and E) based on the resident's limitations and ability to cooperate during the transfer. Locomotion (Knibbe & Knibbe)

T: +44 1656 776222
uk@invacare.com
www.invacare.co.uk
www.invacare.ie

Invacare UK & Ireland
Unit 4 Pencoed
Technology Park
Bridgend CF35 5AQ

