

Monteringsanvisning
Montageanleitung

Assembly instruction
Instructions de montage

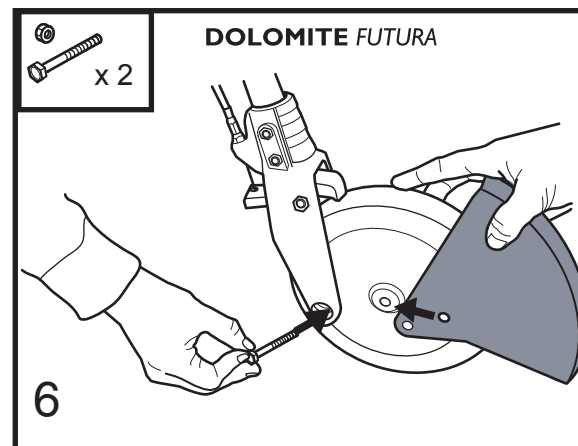
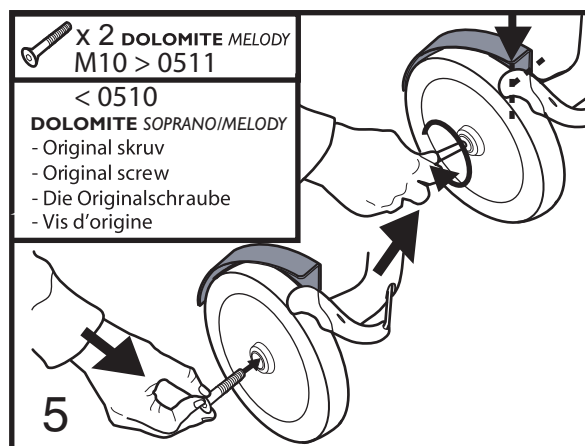
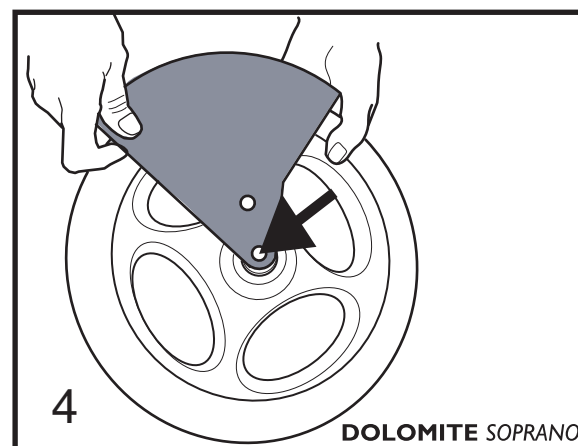
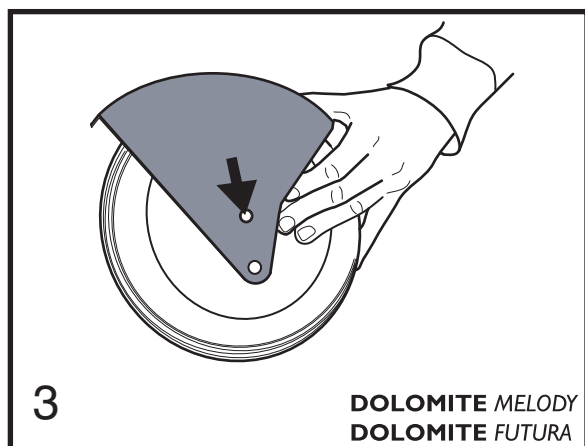
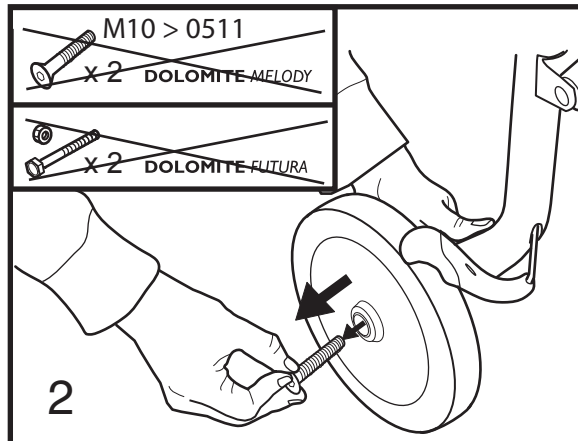
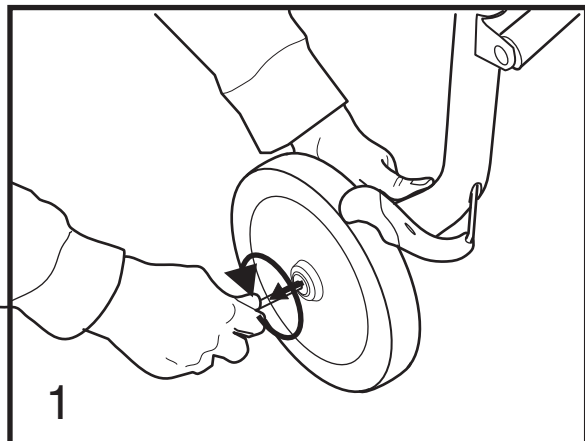

SV Vid demontering av hjulskyddet monteras originalskruven tillbaks igen.

GB When disassembling the wheel guard, the original screw must be used again.

DE Bei Demontage des Radschutzes muss die Originalschraube weiterverwendet werden.

FR Lors du démontage de la protection de roue, la vis d'origine doit être remise à sa place.

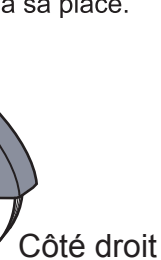
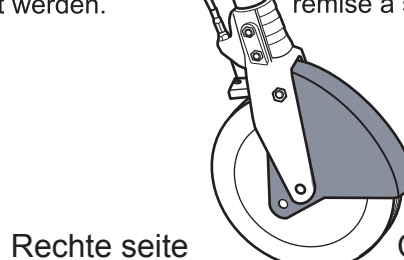
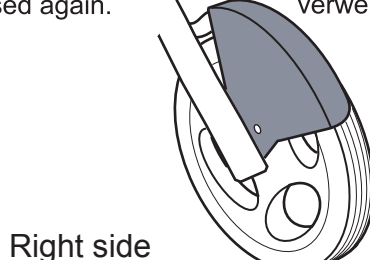
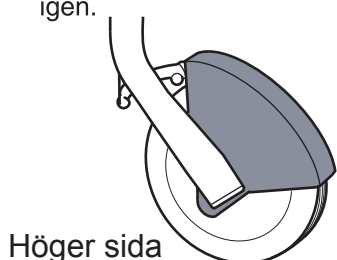

Art no 82067 0605:3