



Küschall® Element

en **Manual wheelchair
Service Manual**



PROVIDER: Keep this manual.
The procedures in this manual **MUST** be performed by a qualified technician.

Küschall®
UNLIMIT YOUR WORLD

Contents

1 General	3
1.1 Introduction	3
1.2 Delivery check	3
1.3 Symbols in This Manual	3
1.4 Limitation of Liability	3
2 Safety	4
2.1 General Safety Information	4
2.2 General Repair Information	4
2.3 Personal Safety Information	4
3 Product Overview	5
3.1 Main parts of the wheelchair	5
3.2 Dimensions and weight	5
4 Maintenance	7
4.1 Safety information	7
4.2 Flat tire	7
4.3 Cleaning	7
4.4 Inspection checklist	7
4.5 Spare parts	8
4.6 Multi stretch polyurethane (PU) coated fabric	8
4.7 Disinfection	8
5 After Use	9
5.1 Recycling	9
5.2 Waste disposal	9
6 Troubleshooting	10
6.1 Troubleshooting	10
7 Instructions	11
7.1 Frame overview	11
7.2 Backrest	11
7.2.1 Adjusting the Seat Unit Angle	11
7.2.2 Replacing backrest cushion	11
7.3 Footrests	11
7.3.1 Adjusting the footplate height	11
7.3.2 Replacing the footplate	11
7.4 Sideparts	11
7.4.1 Replacing the mudguard	11
7.5 Castors	11
7.5.1 Replacing the castor wheel	11
7.5.2 Replacing the castor fork	12
7.6 Rear Wheels	12
7.6.1 Ensuring the rear wheels are parallel	12
7.6.2 Adjusting the Removable Axle	13
7.6.3 Repairing or changing an inner tube	13
7.6.4 Replacing rear wheel spokes	13
7.7 Parking brakes	13
7.7.1 Installing the parking brake	13
8 Options	14
8.1 Installing the Anti-tip device	14
8.2 Installing the Positioning Belt	15

1 General

1.1 Introduction

This document contains important information about assembly, adjustment and advanced maintenance of the product. To ensure safety when handling the product, read this document and the user manual carefully and follow the safety instructions.

Find the user manual on Invacare's website or contact your Invacare representative. See addresses at the end of this document.

Invacare reserves the right to alter product specifications without further notice.

Before reading this document, make sure you have the latest version. You find the latest version as a PDF on the Invacare website.

Previous product versions may not be described in this manual's current revision. If you require assistance, please contact Invacare.

For pre-sale and user information, see the user manual.

For more information about the product, for example product safety notices and product recalls, contact your Invacare representative. See addresses at the end of this document.

1.2 Delivery check

Any transport damage must be reported immediately to the transport company. Remember to keep the packaging until the transport company has checked the goods and a settlement has been reached.

1.3 Symbols in This Manual

Symbols and signal words are used in this document and apply to hazards or unsafe practices which could result in personal injury or property damage. See the information below for definitions of the signal words.



WARNING!

Indicates a hazardous situation that could result in serious injury or death if it is not avoided.



CAUTION!

Indicates a hazardous situation that could result in minor or slight injury if it is not avoided.



NOTICE!

Indicates a hazardous situation that could result in damage to property if it is not avoided.



Tips and Recommendations

Gives useful tips, recommendations, and information for efficient, trouble-free use.



Tools

Gives useful tips, recommendations, and information for efficient, trouble-free use.

1.4 Limitation of Liability

Invacare accepts no liability for damage arising from:

- Non-compliance with the user manual
- Incorrect use
- Natural wear and tear
- Incorrect assembly or set-up by the purchaser or a third party
- Unauthorized modifications, combinations and/or use of unsuitable spare parts

2 Safety

2.1 General Safety Information



WARNING!

Risk of injury or property damage

The information contained in this manual must be performed by a qualified technician. Invacare expects that the qualified technician is familiar with the product, with good technical knowledge to understand and follow the steps of the described instructions in this manual, and equipped with proper tools.

- Installation or repairs made by unqualified persons can result in hazardous situations to the users.
- Failure to carefully read and follow all instructions in this manual can result in equipment malfunction, property damage, personal injury and/or death.



NOTICE!

Refer to the user manual of this product for information on:

- Technical data
- Product components
- Labels
- Additional safety instructions

The information contained in this document is subject to change without notice.



NOTICE!

Medical Devices must be identified at all times to ensure their traceability.

- If the component where the product label with the serial number is located is replaced, or if the product label is no longer readable, a new product label must be requested from Invacare.
- If you have any doubts regarding labeling, please contact Invacare.

2.2 General Repair Information



NOTICE!

Some replacement parts are only available as a kit. Always use the complete new kit when replacing a part.

- Use only original spare parts.
- Spare parts can be ordered from Invacare. Refer to your local Invacare website to access the electronic spare parts catalogue (ESPC).

Tightening torques

Correct tightening will allow safe and durable use of the device. All bolts must be tightened with the torques specified in the following instructions. If not specified, use the table below.

All values apply to dry and grease-free threads.

Thread diameter	M4	M5	M6	M8	M10/12
Tightening torque (mini/max)	1,5/3 Nm	3/6 Nm	7/12 Nm	10/20 Nm	20/30 Nm



WARNING!

Risk of injury or damage to property

- After each assembly, check that all fittings are properly tightened AND that all parts have the correct function.

2.3 Personal Safety Information

These safety instructions are intended to help avoid accidents during work and must be observed under all circumstances. All employees coming into contact with contaminated products must regularly consult a company doctor. Work clothing and personal protective equipment must be available in necessary quantities and be in proper condition. Reliable hand and surface disinfection must be ensured.



WARNING!

Risk of contamination

- Clean and disinfect the product before carrying out repairs.



The technician should work in an environment (light, space, access to the wheelchair, ...) that allows him to work safely.

3 Product Overview

3.1 Main parts of the wheelchair

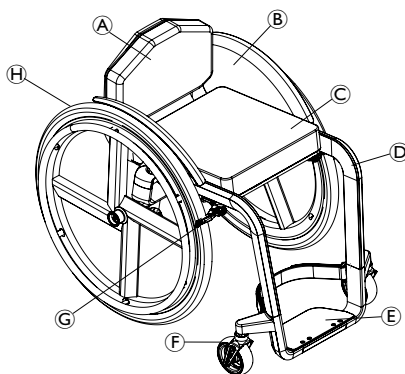

Ⓐ	Backrest
Ⓑ	Clothes-guard
Ⓒ	Seat with cushion
Ⓓ	Frame
Ⓔ	Footrest
Ⓕ	Castor fork with castor wheel
Ⓖ	Parking brake
Ⓗ	Rear wheel with handrim

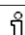
 The equipment of your wheelchair may differ from the diagram as each wheelchair is manufactured individually to the specifications in the order.

3.2 Dimensions and weight

All dimension and weight specifications refer to a wide range of the wheelchair in a standard configuration. Dimension and weight (based on ISO 7176-1/5/7) may alter according to different configurations. In some configurations, the wheelchair exceeds the recommended dimensions for a wheelchair.



NOTICE!

- In some configurations, the overall dimensions of the wheelchair when it is ready for use exceeds the authorised limits and the access to emergency escape routes is not possible.
- In some configurations, the wheelchair exceeds the size recommended for travelling by train in the EU.



The dimensions are measured with cushion and dummy.

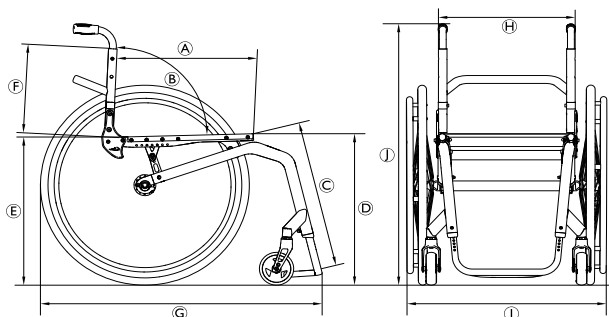

	Maximum load of the wheelchair (*)	100 kg
Ⓐ	Seat depth	415 – 440 – 465 mm
Ⓑ	Backrest angle	88°
Ⓒ	Lower leg length	425 – 495 mm, in increments of 10 mm
Ⓓ	Front seat-to-floor height	520 – 540 mm, in increments of 10 mm
Ⓕ	Backrest height	260 – 320 mm, in increments of 15 mm
Ⓖ	Overall length with legrest	90° frame angle: 865 mm
Ⓗ	Seat width	355 – 435 mm, in increments of 20 mm
Ⓘ	Overall width	approx. 575 – 655 mm
Ⓙ	Overall height	approx. 735 – 795 mm
	Total weight	approx. 12.9 kg
	Weight of the heaviest part	8.2 kg
	Pivot width	1050 mm
	Minimum turning radius	685 mm
	Maximum slope for use of parking brakes	7°
	Static stability downhill	25.1°
	Static stability uphill	9.1° (with 8° seat angle) 4.8° (with 12° seat angle)
	Static stability sideways	19°
	Seat plane angle	15°
	Leg to seat surface angle	83°
	Handrim diameter	532 mm
	Horizontal location of axle	75 mm

(*) The maximum load of the wheelchair is the total of the maximum occupant mass and the maximum mass of any other items intended to be carried by the wheelchair.

The maximum occupant mass is the maximum load of the wheelchair without additional load.

E.g.: for a wheelchair with a back pack of 10kg:

Maximum Occupant Mass = Maximum Load of the wheelchair = 10kg

4 Maintenance

4.1 Safety information

Regular checks and maintenance of the wheelchair ensure the user's safety and the expected lifetime of the chair.

4.2 Flat tire

-  In case of a tire puncture consult a suitable workshop (e.g. bike repair shop, bicycle dealer ...) to have the tube replaced by a skilled person.

4.3 Cleaning

- !** **NOTICE!**
— The product does not tolerate cleaning in automatic washing plants, with high-pressurecleaning equipment or steam.

- !** **NOTICE!**
Dirt, sand and seawater can damage the bearings and steel parts can rust if the surface is damaged.
— Only expose the wheelchair to sand and sea water for short periods and clean it after every trip to the beach.
— If the wheelchair is dirty, wipe off the dirt as soon as possible with a damp cloth and dry it carefully.

1. Remove any options fitted (only options which do not require tools).
2. Wipe down the individual parts using a cloth or soft brush, ordinary household cleaning agents (pH = 6 - 8) and warm water.
3. Rinse the parts with warm water
4. Thoroughly dry the parts with a dry cloth.



-  Car polish and soft wax can be used on painted metal surfaces to remove abrasions and restore gloss.

Cleaning upholstery

For cleaning upholstery refer to the instructions on the labels of the seat, cushion and backrest cover.

-  If possible, always overlap hook and loop strips (the self-gripping parts) when washing, to minimize lint and thread build-up on hook strips and prevent damage to upholstery fabric by these.

4.4 Inspection checklist

General inspection		
Is the product in good condition and is it complete (product and optional equipment)?	<input type="checkbox"/>	<input type="checkbox"/>
Is the product free from damage or weaknesses of any kind?	<input type="checkbox"/>	<input type="checkbox"/>
Does the product operate correctly under nominal load?	<input type="checkbox"/>	<input type="checkbox"/>
Is the product fully functional in accordance with the user manual?	<input type="checkbox"/>	<input type="checkbox"/>
Eradication of faults	<input type="checkbox"/>	<input type="checkbox"/>
Have all the faults found been eliminated and have faulty components been replaced?	<input type="checkbox"/>	<input type="checkbox"/>
Are all screws/bolts firmly fitted and is the product securely assembled?	<input type="checkbox"/>	<input type="checkbox"/>
Completion of checks	<input type="checkbox"/>	<input type="checkbox"/>
Is the product technically and functionally safe?		
Has the product been cleaned and disinfected?	<input type="checkbox"/>	<input type="checkbox"/>
Is the identification label easily readable and is it securely mounted on the product?	<input type="checkbox"/>	<input type="checkbox"/>
Is the product accompanied by the latest revision of the user manual?	<input type="checkbox"/>	<input type="checkbox"/>

4.5 Spare parts

All spare parts must be obtained from the Invacare customer service department. An electronic spare parts catalogue can be found on your local Invacare website.

**WARNING!****Risk of injury due to damaged or worn parts**

Original spare parts must be used in all repairs. Otherwise the warranty and product declaration of conformity shall be rendered invalid.

4.6 Multi stretch polyurethane (PU) coated fabric

Lighter stains on the fabric may be neutralized with a soft damp cloth and some neutral detergent. To neutralize larger, more persistent stains, wipe the fabric with alcohol or turpentine substitutes, and wash with hot water and a neutral detergent.

The fabric can be washed at temperatures up to 60° C. Normal detergents can be used.



All parts of the wheelchair with multi stretch polyurethane (PU) coated fabric upholstery, such as armrest pads, calf pads, headrest or neckrest, should be cleaned according to the instruction above.

4.7 Disinfection

The wheelchair may be disinfected by spraying or wiping with tested, approved disinfectants.



Spray a soft cleaning and disinfecting product (bactericidal and fungicide meeting the EN1040 / EN1276 / EN1650 standards) and follow the instructions given by the manufacturer.

1. Wipe down all generally accessible surfaces with a soft cloth and ordinary household disinfectant.
2. Allow the product to air-dry.

5 After Use

5.1 Recycling

The wheelchair can be divided into the following main components:

- Chassis
- Plastic parts
- Upholstery
- Wheels, tires and tube
- Packing

5.2 Waste disposal

Please be environmentally responsible and recycle this product through your recycling facility at its end of life.

Waste disposal must comply with the laws and regulations pertaining waste handling in each country.

Invacare® is continuously working towards ensuring that the company's impact on environment, locally and globally, is reduced to a minimum.

We comply with the current environment legislation (e.g. WEEE and RoHS directive).

We only use REACH compliant materials and components.

The wheelchair can be divided into the following main components:

Chassis

- The chassis is produced in steel and is fully recyclable.
- Recycling of steel requires only 20-25% of the energy compared to new produced steel.
- The wheelchair has two gas pistons and they contain oil and must be disposed according to national requirements.

 Be aware of that the gas pistons contains high pressure and must be handled with care during destruction.

Plastic parts

- The plastic parts in the chairs are produced of "Thermoplastic" and are marked with recycling symbols (where it is possible due to part size).
- The main plastic material is polyamide.
- The plastic materials for the table are ABS and polyamide.
- This material can be recycled or burned in approved facilities.

Upholstery

- Upholstery is produced of polyester fibres (PUR) and Dartex®.
- The efficient way to recycle the parts is to burn them in approved facilities.

Wheels, tires and tubes

- The handrim, rim, spokes and hub are made of steel, stainless steel or aluminium and can be recycled according to above.
- Tires and tubes are made of rubber and can be recycled according to above.

Packing

- All packing material is developed to fit the products in an optimal way to reduce unnecessary material waste.
- All boxes are recyclable.

Electrical and Electronic equipment

This product has been supplied from an environmentally aware manufacturer that complies with the Waste Electrical and Electronic Equipment (WEEE) Directive 2012/19/EU. This product may contain substances that could be harmful to the environment if disposed of in places (landfills) that are not appropriate according to legislation.

End of life

At the end of this products life, it should be recycled according to laws and regulations for waste handling in each country.

 Contact your local recycling agent to obtain the correct information on how to handle the above mentioned materials.

6 Troubleshooting

6.1 Troubleshooting

The following items must be reviewed and checked when reconditioning is required:

Symptoms	Possible causes	Solution
The wheelchair does not travel in a straight line	Incorrect tyre pressure on one rear wheel	Correct tyre pressure, see user manual
	One or more spokes broken	Replace broken spoke(s)
	Spokes tightened unevenly	Tighten loose spoke(s)
	Castor wheel bearings are dirty or damaged	Clean or replace the bearings or the complete castor wheel 6.6.1 Replacing the castor wheel, page 21
	Support bearings in forks faulty	Replace the support bearings, see 6.6.2 Replacing the castor fork, page 21
The wheelchair tips backward too easily	Backrest angle too large	Reduce backrest angle by replacing the backrest, see 6.3.3 Replacing the Backrest / Backrest Bands, page 14
	Seat unit too rearward	Move the seat unit frontward
	Seat angle too large	Adjust the front seat-to-floor height respectively the rear seat-to-floor height, see 6.2.1 Adjusting the seat height (SH), page 11
The parking brakes are gripping poorly or asymmetrically	Incorrect tyre pressure in one or both rear tyres	The parking brakes Correct tyre pressure, see user manual
	Brake setting incorrect	Correct brake setting, see 6.8.2 Adjusting the parking brake, page 25
The castors wobble when moving fast	Too little tension on the clevis pin housing	Tighten the screw on the castor fork slightly, see 6.6.2 Replacing the castor fork, page 21
	Castor wheel is worn out	Replace the castor wheel, see 6.6.1 Replacing the castor wheel, page 21
The castor wheel is stiff or stuck	Bearings are dirty or faulty	Replace the bearings, see 6.6.1 Replacing the castor

7 Instructions

7.1 Frame overview

Adjusting the frame

The seat width, seat depth, lower leg length and tipping point are determined by the design of the frame and cannot be changed retrospectively; only the seat unit can be adjusted in depth and angle. A modification of the tip behaviour can only be achieved by ordering a new, one-off backrest. The seat depth can be adjusted by changing the hole position.

Changing the frame

Contact the Invacare Customer Service department if you wish to change the frame.

7.2 Backrest

7.2.1 Adjusting the Seat Unit Angle

Adjusting seat unit angle and depth: 2 fixations are available generating a seat angle of 8° or 12°, +/- 15 mm adjustment possible in depth. Backrest to seat angle is fixed and cannot be changed.



CAUTION!

Risk of instability

The adjustment of the seat in position (frontward/backward) impacts:

- Stability - the seat frontwards makes the wheelchair more stable.
- Maneuverability - the seat rearwards makes the wheelchair more maneuverable.



Changing the seat unit angle also modifies the tipping point of the wheelchair.

7.2.2 Replacing backrest cushion

To replace the backrest cushion, there is no need of any tool, just unzip and fit the new cushion from our spare parts catalogue.

7.3 Footrests

The footrest are fixed, a carbone plate is always fixed on the structure, that plate can be adjusted in height with or without a pair of spacer (10 mm adjustment possible in height).

7.3.1 Adjusting the footplate height



Allen Key 3 mm with torque 5 Nm

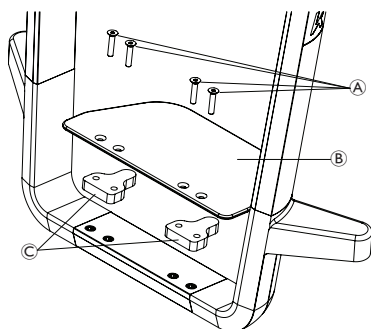

1. Remove the 4 screws (A).
2. Remove the footplate (B).

3. Remove or add the 2 wedges (C) (1 wedge in maximum).
4. Place the wedge or the long screw if you have wedge.

7.3.2 Replacing the footplate



Allen Key 3 mm with torque 5 Nm

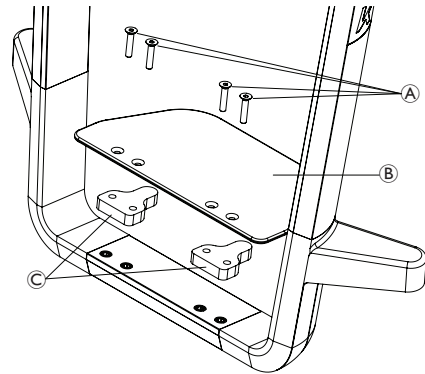

1. Remove the 4 screws (A).
2. Install the new footplate (B) (with the same size).
3. Retighten the 4 screws (A).

7.4 Sideparts

Nine different mudguard sizes are available. The mudguards are made from carbon fiber.

7.4.1 Replacing the mudguard



Allen Key 4 mm with torque 5 Nm

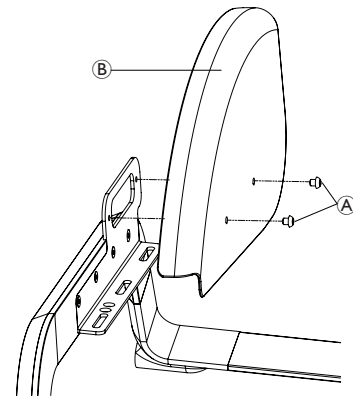

The mudguard is customized to fit the geometry of the individual wheelchair. It must therefore only be replaced by another mudguard of the same size.

1. Remove the screws (A) and the mudguard (B).
2. Install the new mudguard by following step 1 in reverse side.

7.5 Castors

7.5.1 Replacing the castor wheel



NOTICE!

The following sub-assembly contains pre-coated screws.

- Only use original Invacare spare parts.
- If the screws need adjustment, replace by new ones.



Allen Key 4 mm with torque 5 Nm

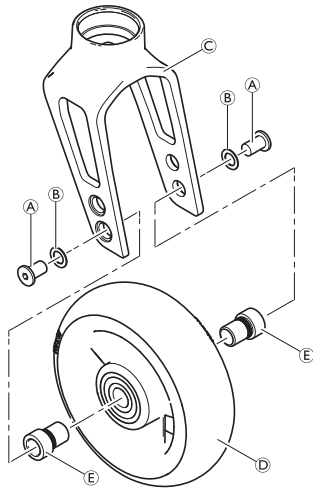

1. Remove the screws (A) and the washers (B).
2. Remove the castor wheel (D) from the castor fork (C).
3. Place the sleeves (E) in the bearing of the new castor wheel.
4. Place the castor wheel with sleeves in the required position of the fork.
5. Secure the castor wheel to the fork using screws and washers.

Function check:

The wheel may not wobble, but must rotate easily.

7.5.2 Replacing the castor fork**NOTICE!**

The following sub-assembly contains pre-coated screws.

- Only use original Invacare spare parts.
- If the screws need adjustment, replace by new ones.



Socket spanner (10 mm) / Wrench (17 mm)

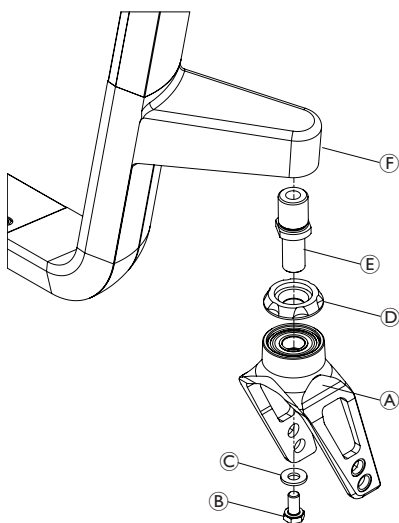

1. Remove the castor wheel, see 7.5.1 *Replacing the castor wheel, page 11*.
2. Remove bolt (B), washer (C), the castor fork (A) and part (D) from the threaded bolt (E).

3. If necessary, turn the threaded bolt (E) out of the supporter (F) and replace with a new one. Apply high-strength adhesive on the thread.
4. Replace the castor fork and reinstall in reverse order.
5. Reinstall the castor wheel.

**NOTICE!**

Risk of damaging the castor fork bearing

- Do not overtighten the bolt (B).
- Tighten the bolt only so far that the fork can still be turned freely.

(F) = 13 Nm (high-strength)

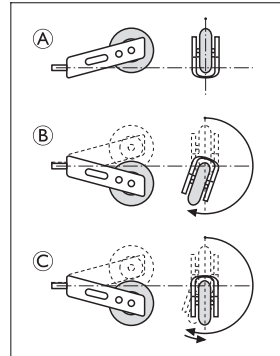
Function check:

Tip the wheelchair backwards by 90° so that it is lying on the backrest and the rear wheels. Make sure that the clevis pin is as horizontal as possible.

Turn the fork upwards (position A) and let it tip downwards. The fork has been correctly adjusted if it easily turns to slightly beyond the bottommost point (position B) and then maximally turns back to the bottommost point (position C). If the fork turns back over the bottommost point or even swings back and forth, it has not been sufficiently tightened. There is a risk that the castor wheel will start to wobble at high speeds.

7.6 Rear Wheels**WARNING!**

Risk of accidents to the wheelchair user

- Check and adjust the anti-tip device and parking brake settings after each change on the rear wheel position.

7.6.1 Ensuring the rear wheels are parallel

Wrench 22 mm and 18 mm

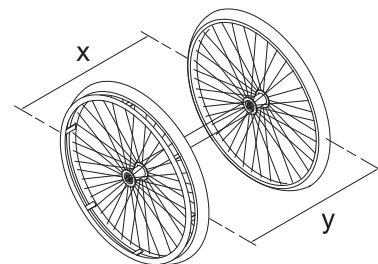

 This setting must be carried out on a horizontal surface. The track of the rear wheels is correct if the distance between the rear wheels is the same at the front and the back ($x=y$) – measured at the height of the centre of the axle.

1. Loosen the nut **A** on both sides.

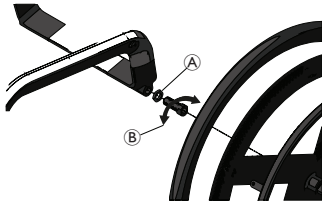

2. Rotate the rear wheel axis **B** to **A** drawing of a wheel.
3. Retighten the nut **A** on both sides without changing rear wheel axis **B** position.

Torque **A** = 15 Nm

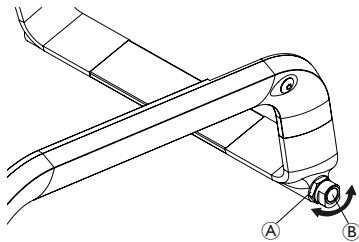

7.6.2 Adjusting the Removable Axle



Open-end spanner (19) / Straddle spanner (11)

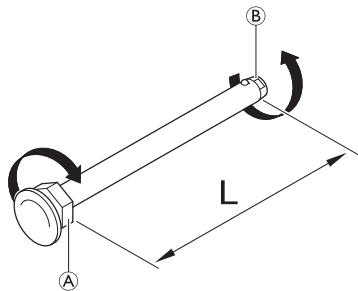

1. Remove the rear wheel.
2. Hold the end of the removable axle **B** using the straddle spanner.
3. Adjust the length **L** of the removable axle by turning the nut **A**. The length is correctly adjusted if the removable axle engages correctly when installing the wheel and the wheel has just minimal clearance.

 The wheels must be exchanged (left to right side and vice versa) after adjusting both removable axles. The adjustment must now be checked or carried out again to ensure the wheels can be switched.

7.6.3 Repairing or changing an inner tube



Tyre lever

1. Remove the rear wheel and release any air from the inner tube.
2. Lift one tyre wall away from the rim using a bicycle tyre lever. Do not use sharp objects such as a screwdriver which could damage the inner tube.
3. Pull the inner tube out of the tyre.

4. Repair the inner tube using a bicycle repair kit or, if necessary, replace the tube.
5. Inflate the tube slightly until it becomes round.
6. Insert the valve into the valve hole on the rim and place the tube inside the tyre (the tube must lie right round the tyre with no creases).
7. Starting close to the valve, push the tyre wall over the edge of the rim using both hands. When doing this, check all the way round to ensure that the inner tube is not trapped between the tyre and the rim.
8. Inflate the tube to its maximum operating pressure. Check that no air is escaping from the tyre.

7.6.4 Replacing rear wheel spokes

We recommend having the spokes replaced by a qualified technician.

7.7 Parking brakes

7.7.1 Installing the parking brake



Allen Key 3 mm and 5 mm

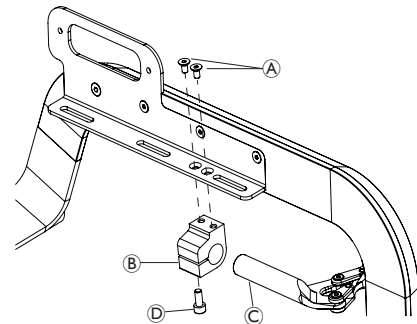

1. Install brake holder on seating bracket with 2 screws **A**.
2. Place the brake **B** in the brake holder **C**.
3. Rotate the brake **B** in the brake holder **C** to achieve a horizontal position of the brake rod to the tyre.
4. Tighten lock screw **D** to block in position the brake.

8 Options

8.1 Installing the Anti-tip device

There are two different sizes of anti-tip device for both the left and the right sides.



Allen key 4 mm

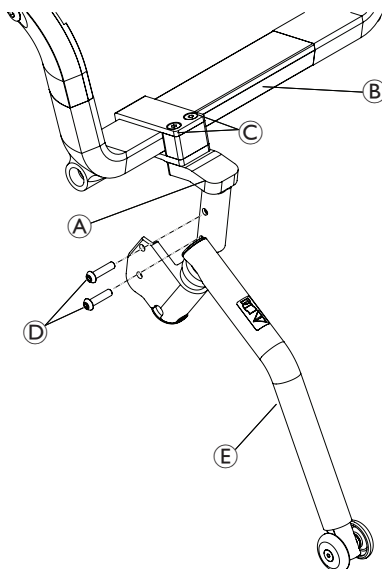

1. Install the anti-tip device holder on the frame (B) (the holder must be on the left junction between aluminium part and wood part).
2. Tighten 2 screws (C) (Torque 1).
3. Install the anti-tip device (E) on the holder.
4. Fix it with 2 screws and bushes (D) inside the tube (E) (Torque 2).
5. Measure the distance between the anti-tip device and the ground and adjust the length of the anti-tip device according to the below description.
6. Ensure that the rear wheels are parallels, see Chapter

Adjusting the length of the anti-tip device

1. Press the spring pin. Slide the inner part of the anti-tip device to the required position until the spring pin locates in the correct hole.

Function control:

The distance between the anti-tip device and the ground must be 50 - 70 mm. It must be easy to fold up the anti-tip device. Tip the wheelchair backwards using the anti-tip device until the axle is perpendicular to the anti-tip device's point of contact with the ground. In this position, the distance between the rear wheel and the ground must be $x \geq 50$ mm.

8.2 Installing the Positioning Belt



Allen Key 4 mm / Wrench 10 mm

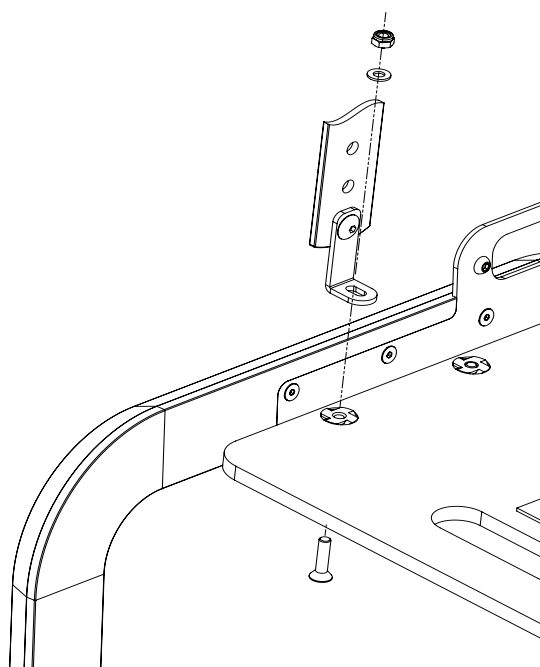

1. Remove the 2 fixation screws of seating plate at the front.
2. Install the long screws at torque 1
3. Install the adapter plate and fix it with washer and nut with torque 2
4. Mount the belt to the adapter plate into the required hole using bolt and nut

Torque 1 = 5 Nm

Torque 2 = 10 Nm



The washer © can be placed between the belt and the nut to avoid the rotation of the belt.



If necessary, reduce the length of the belt by cutting straight across the belt at position ⊕. Trim along the curved line ① for a proper appearance.



United Kingdom & Ireland:

Invacare Limited
Pencoed Technology Park, Pencoed
Bridgend CF35 5AQ
Tel: (44) (0) 1656 776 200
uk@invacare.com
www.invacare.co.uk



Invacare UK Operations Limited
Unit 4, Pencoed Technology Park,
Pencoed
Bridgend CF35 5AQ
UK



Invacare France Operations
Route de St Roch
F-37230 Fondettes
France

1682890-A 2026-01-30



Yes, you can.